

Res # 425 W. Washington ST.

Joe Dilbone

Phone # 419-599-1962

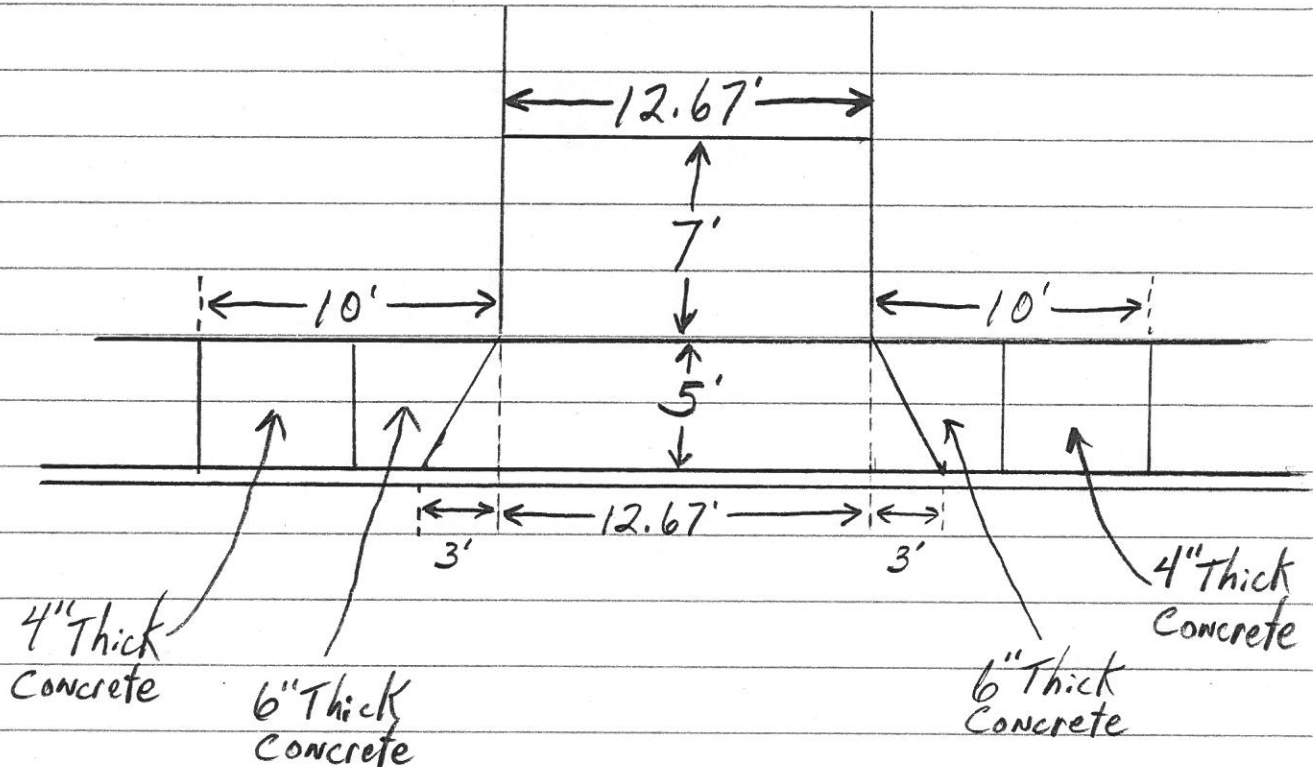

All of Drive Approach + Sidewalk, 5' l.t. on each side of Drive is to be 6" Thick concrete on 6" Thick #304 or #411 stone.

Sidewalk outside of these areas shall be 4" Thick Concrete on 4" Thick #304 or #411 stone

Type 6 curb shall be cut to match slope of drive approach, area directly in front of drive needs to be replaced with new Type 6 curb.

Res # 425 W. Washington ST.

Joe Dilbone

Phone # 419-599-1962

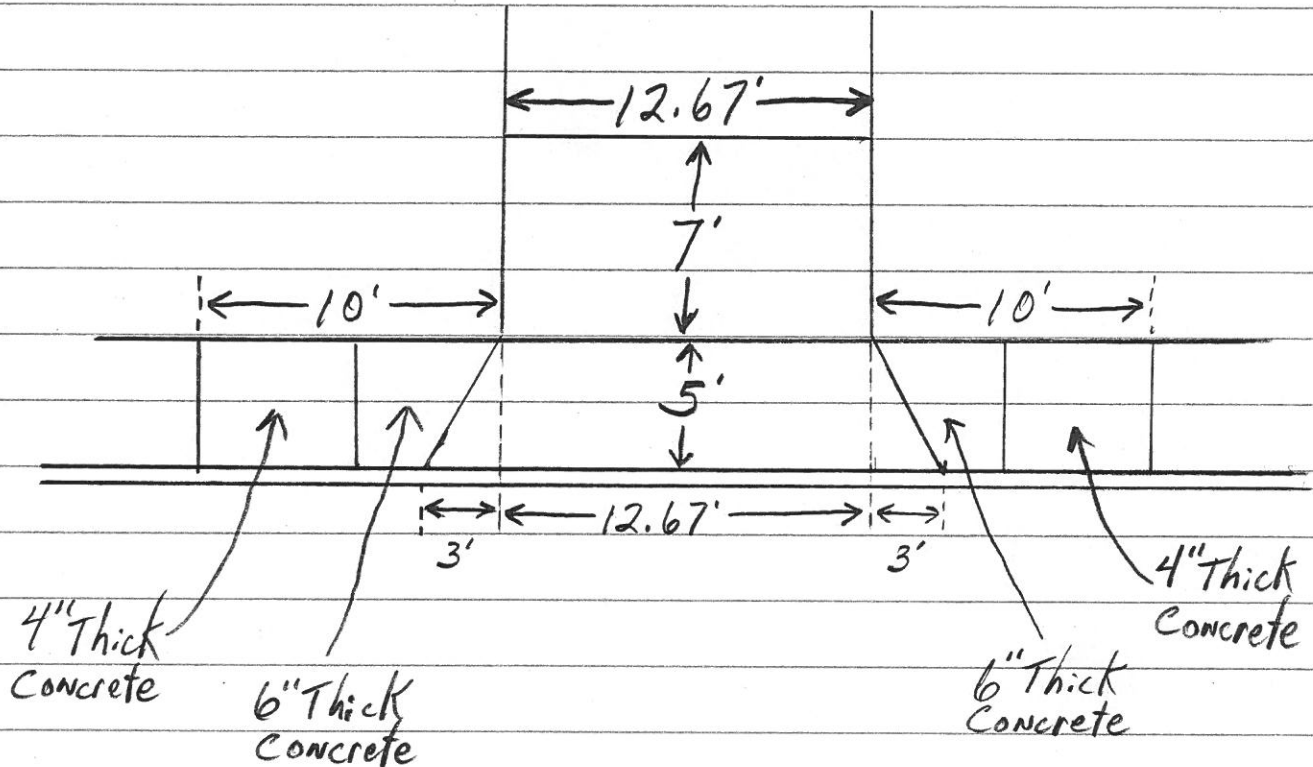

All of Drive Approach + sidewalk, 5' l.f. on each side of Drive is to be 6" Thick concrete on 6" Thick #304 or #411 stone.

Sidewalk outside of these areas shall be 4" Thick Concrete on 4" Thick #304 or #411 stone

Type 6 curb shall be cut to match slope of drive approach, area directly in front of drive needs to be replaced with new Type 6 curb.